

How to Measure Flanges & Gaskets

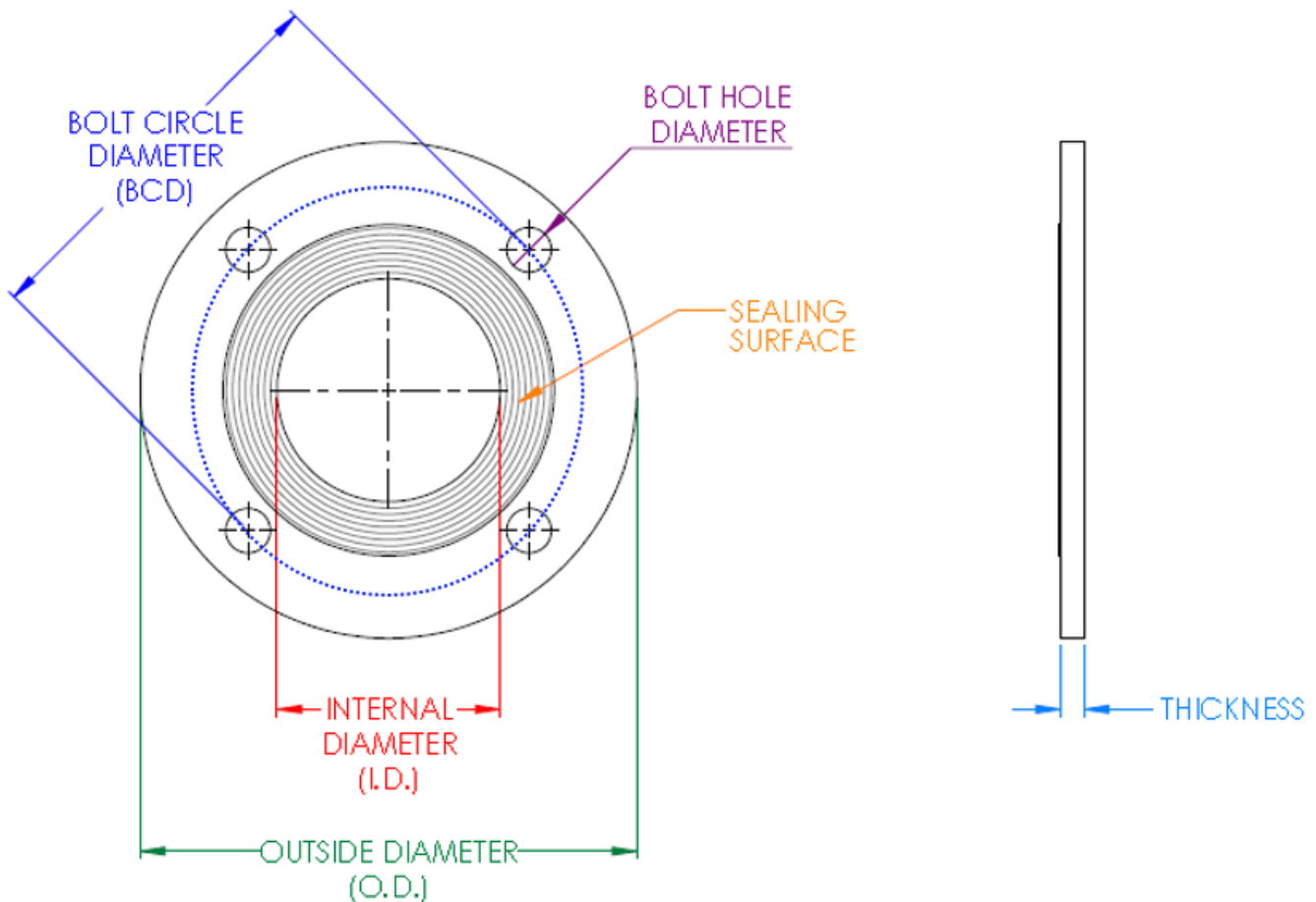

The measuring principles apply to both flanges and gaskets.

*Above is a drawing of a Flange.

The **Bolt Circle** is the measurement (diameter) of an imaginary circle passing through the centers of all the bolts in a round pattern. This is represented by the **Blue Dashed Circle** in the drawing. To measure such circle measure from the center of one bolt directly across to the center of the other bolt.

The **Outside Diameter** is the measurement of the outside of the Flange or Gasket.

The **Inside Diameter** is the measurement of the inside of the hole of a Flange or Gasket.

The **Sealing Surface** is the area of contact the gasket is placed to seal between two flange connections.

All measurements should be made across the center of the flange or gasket.